

....2....

Q.3 The front view and top view of an object shown below. Draw its isometric view. (10)

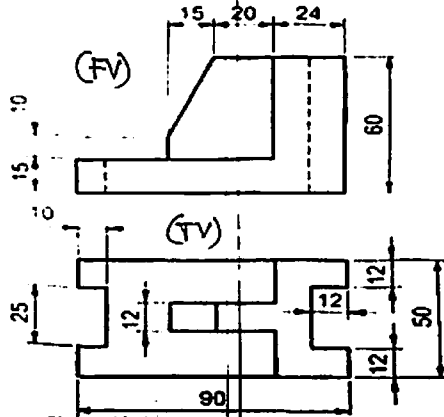

OR

Q.3 The front view and top view of an object. Draw its isometric view. (10)

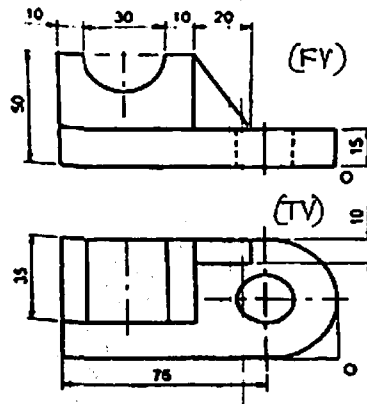

Q.4 Front View of line AB makes 45-degree angle with XY line and measures 60 mm. Line's Top View makes 30 degree with XY line. End A is 15 mm above HP and its VT is 10 mm. below HP. Draw projections of line AB, determine inclinations with HP and VP and locate HT, VT. (10)

OR

Q.4 A regular pentagon of 30 mm sides is resting on HP on one of its sides while its opposite vertex (corner) is 30 mm above HP. Draw projections when the side in HP is 30 degrees inclined to VP. (10)

Q.5 Draw the projection of hexagonal prism whose one rectangular face is 25 mm x 65 mm resting on HP on one of its base corners such that the other extreme corner is 30 mm above HP with the axis parallel to VP. (10)

OR

.....3.....

- Q.5 A right hexagonal pyramid, edge of base 25 mm and height 50mm, rests on one of its base HP with its axis parallel to VP. Draw the projections of the pyramid when its base make an angle of 45° to the HP. (10)
- Q.6 Cylinder of base diameter 50 mm and axis 70 mm is resting on the ground with its axis vertical. It is cut by a section plane perpendicular to VP, inclined at 45 degrees to HP, passing through the top of the generator and cuts all the other generators. Draw the development of its lateral surface. (10)

OR

- Q.6 A right circular cone having a diameter of base 50 mm, axis length 70 resting on its base on HP is cut by a section plane inclined at 45 degrees to HP and bisecting the axis. Draw development of cone retaining the portion containing base. (10)

* * * *
